

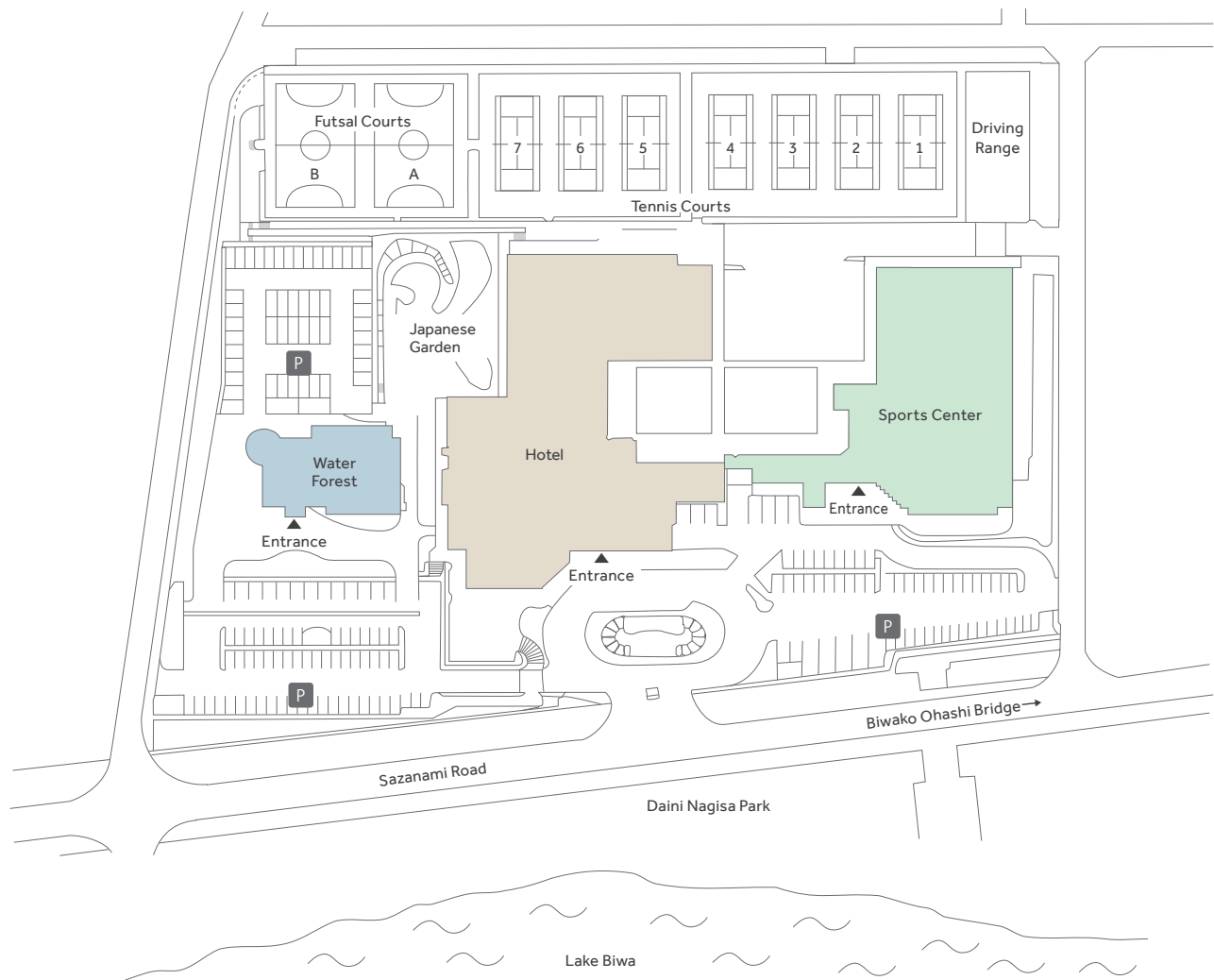

LAKE BIWA MARRIOTT HOTEL

RESORT MAP

We are located on the shore of Lake Biwa, the largest lake in Japan.
We invite you to enjoy an active and refreshing stay at Lake Biwa Marriott Hotel, which boasts a spectacular lake view.



FLOOR PLANS

This 12-story resort complex offers a broad range of guestrooms and venues for meetings, incentives, conferences, and exhibitions, as well as fitness and entertainment facilities for a diverse resort experience.

B1F

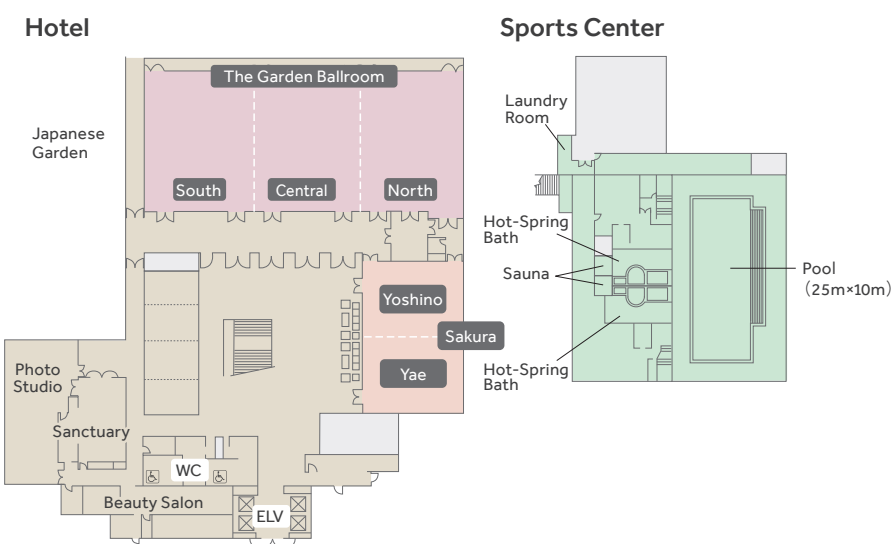

1F

Water Forest

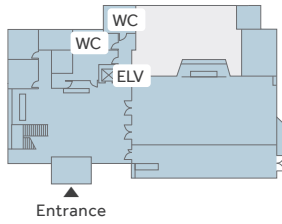

Hotel



Sports Center



2F

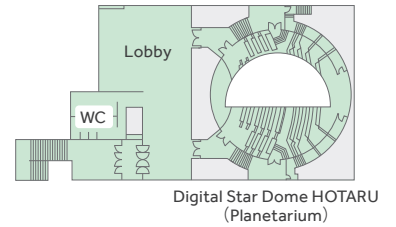
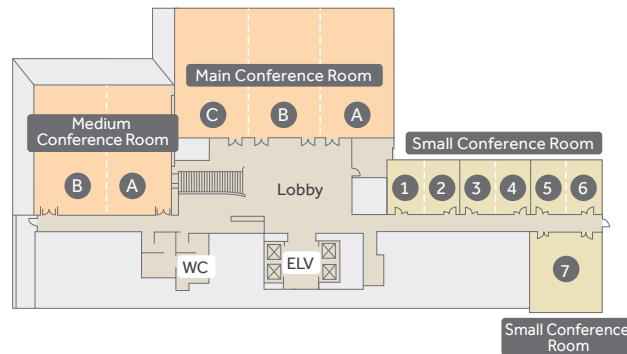

3F

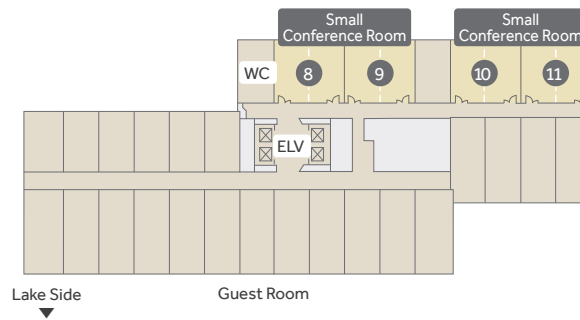

4-11F

Example: 4 to 10F

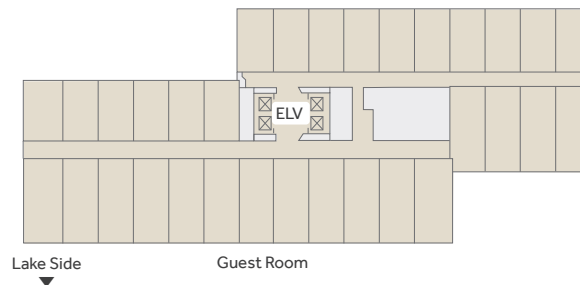

12F

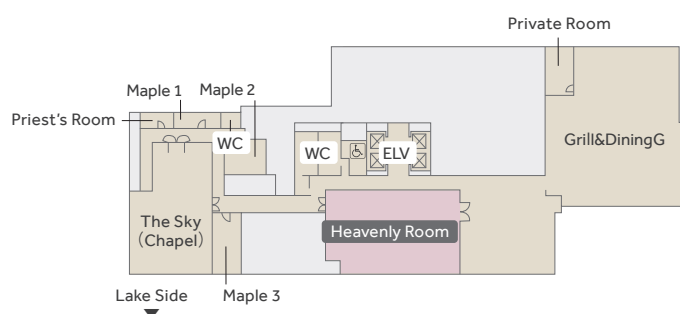

CONFERENCE ROOMS

From large conference rooms capable of accommodating over 350 people to small conference rooms convenient for smaller meetings and breakout sessions. We offer state-of-the-art facilities and smart services to ensure highly productive meetings.



Main Conference Room



Medium Conference Room



Small Conference Room

Main Conference Room 2F

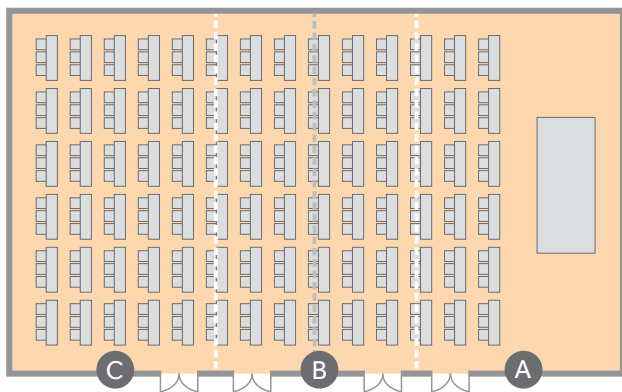

Medium Conference Room 2F

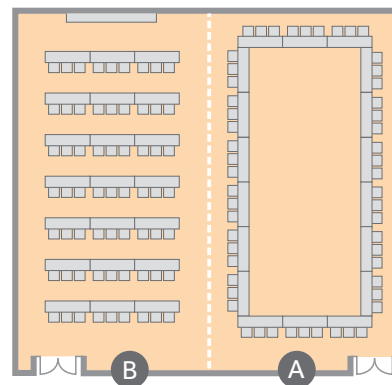

Small Conference Room 2F

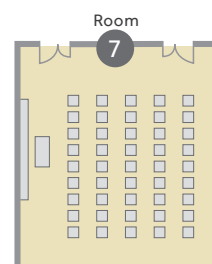
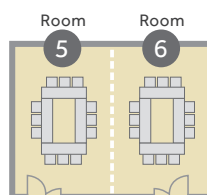
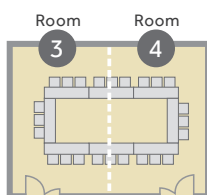
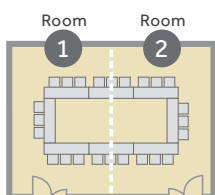

Small Conference Room 3F

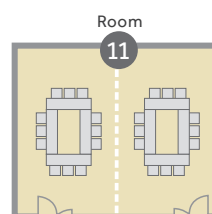
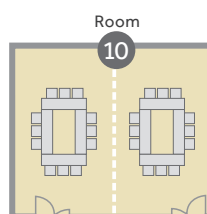
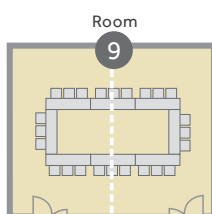
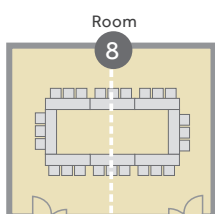

Name	Specification	Room Size (m²)	Ceiling Height (m)	Capacity			
				Theatre	Classroom	Hallow-Square	U-Shape
Main Room	A • B • C	378	2.8	374	252	84	-
	2/3	252	2.8	242	162	72	-
	1/2	189	2.8	178	108	60	39
	1/3	126	2.8	80	63	54	33
Medium Room	A • B	230	2.7	180	144	66	-
	A	116	2.7	72	63	54	33
	B	116	2.7	72	63	54	33
Small Room	Room1 • 2	50	2.7	30	24	24	18
	Room1	25	2.7	9	6	12	9
	Room2	25	2.7	9	6	12	9
	Room3 • 4	50	2.7	30	24	24	18
	Room3	25	2.7	9	6	12	9
	Room4	25	2.7	9	6	12	9
	Room5 • 6	50	2.7	30	24	24	18
	Room5	25	2.7	9	6	12	9
	Room6	25	2.7	9	6	12	9
	Room7	71	2.7	45	36	30	21
	Room8	60	2.7	30	24	24	18
	1/2	28	2.7	9	6	12	9
	Room9	60	2.7	30	24	24	18
	1/2	28	2.7	9	6	12	9
	Room10	60	2.7	30	24	24	18
	1/2	28	2.7	9	6	12	9
	Room11	60	2.7	30	24	24	18
	1/2	28	2.7	9	6	12	9

Internet Environment

Wireless LAN connection, wired Internet (free of charge)

Rental Equipment

Wireless microphones, lapel microphones, whiteboards, screens, projectors, laser pointers, etc. (for a charge)

*Table size: 1,800 × 450 mm; The listed seating capacity assumes 3 guests per table

BANQUET ROOMS

A spacious banquet room for large-scale parties and a venue on the top floor with a panoramic view of Lake Biwa. Feel free to choose the venue that best suits the number of guests and the occasion.



The Garden Ballroom



The Garden Ballroom



Heavenly Room

The Garden Ballroom

B1F

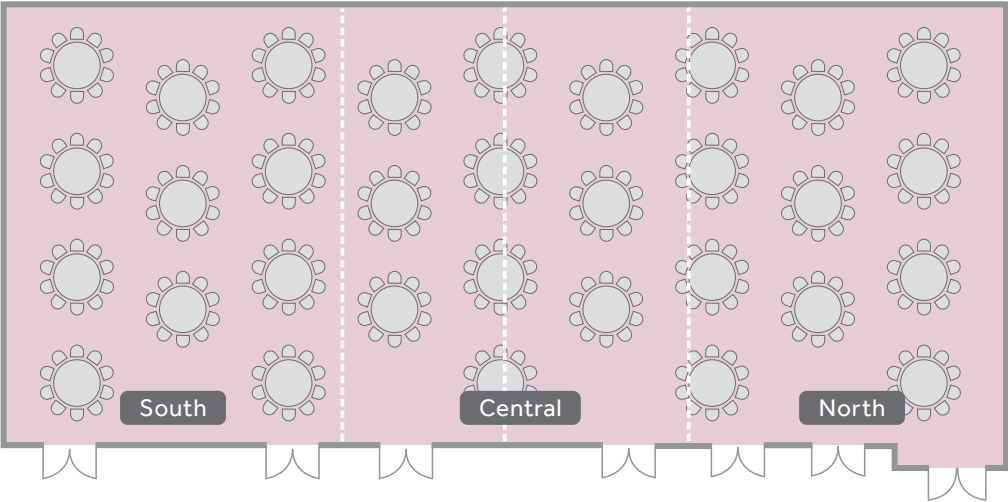

Sakura

B1F

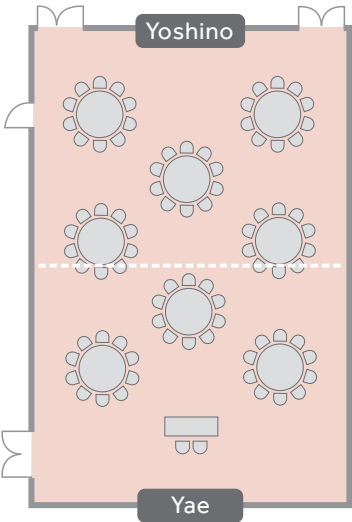

Heavenly Room

12F

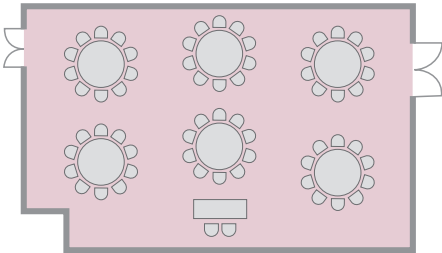

Name	Specification	Room Size (m ²)	Ceiling Height (m)	Capacity	
				Standing Buffet	Banquet
The Garden Ballroom	All	577	6.9	500	320
	2/3	383	6.9	250	180
	North Side	318	6.9	200	130
	South Side	252	6.9	160	110
	1/3	187	6.9	100	80
Sakura	All	206	3.2	120	80
	Yoshino	105	3.2	50	30
	Yae	93	3.2	40	30
Heavenly Room		179	4.3	80	60

Internet Environment

Wireless LAN connection, wired Internet access (free of charge)

Rental Equipment

Wireless microphones, lapel microphones, screens, projectors, etc. (for a charge)

GUEST ROOMS

All of our spacious 274 guestrooms are over 30 square meters in size. The designs are inspired by the pure water and natural environment of the Lake Biwa area, providing both warmth and comfort within a chic ambiance.

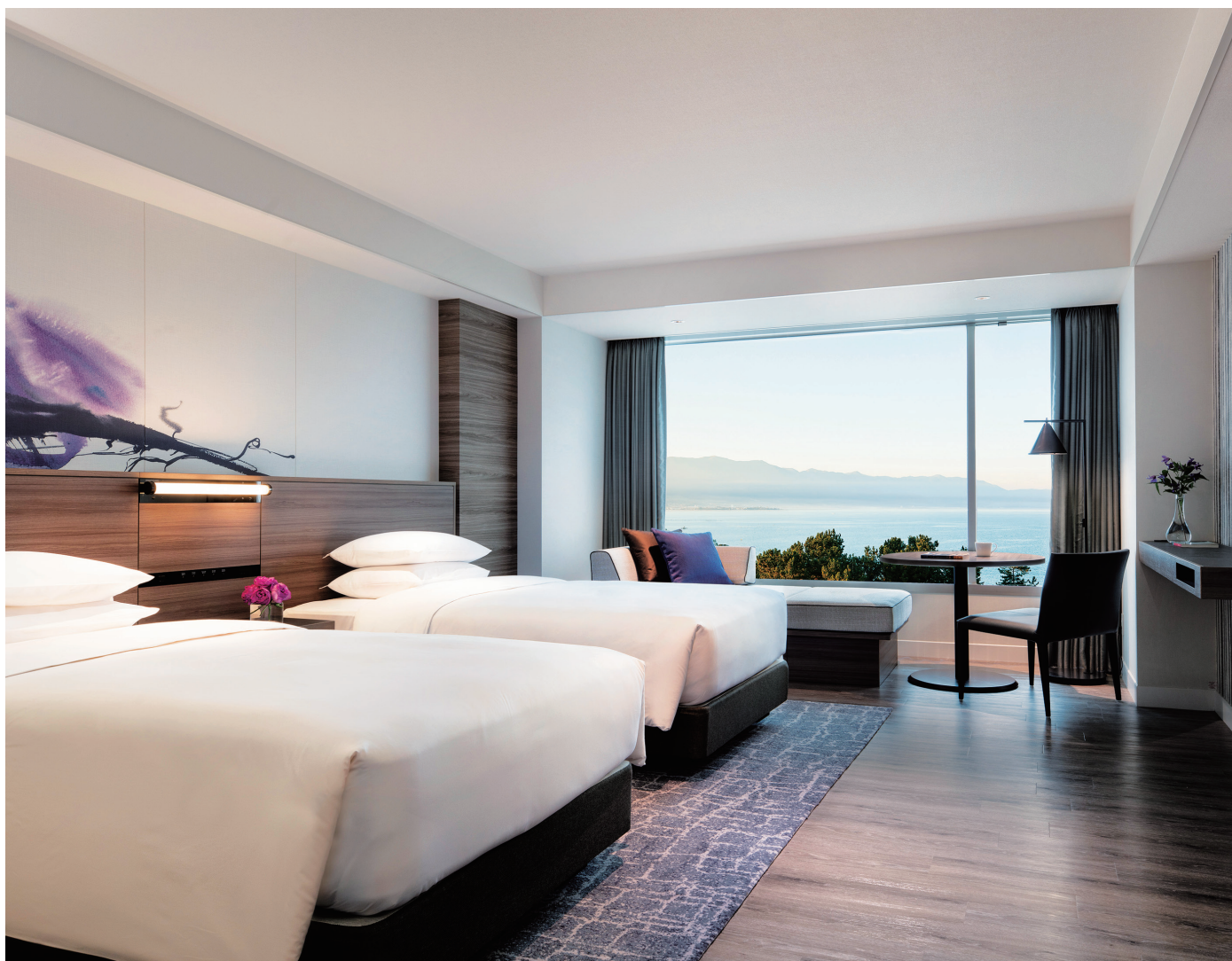

Deluxe Room (Twin)



Junior Suite



Superior Room (King)

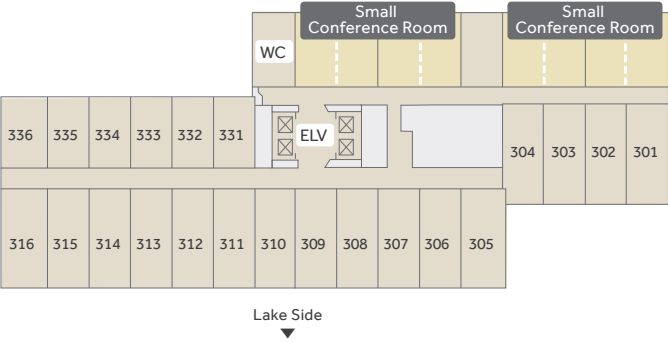

Example: 4F

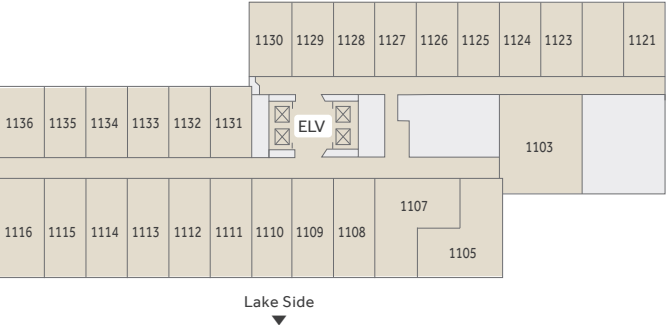
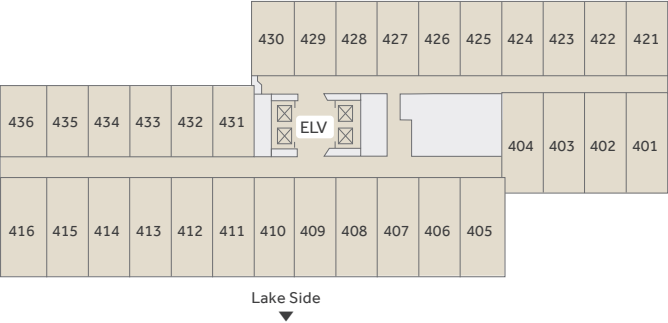

Guest Room		Occupancy	Room Size (m ²)	Number of Rooms
Superior Room*	Twin	2 - 3	30	96
	King	2 - 3	30	32
Japanese Room	-	2 - 4	40	48
Deluxe Room	Twin	2 - 3	40	36
	King	2 - 3	40	12
Premium Room with Hot-Spring Bath	Twin	2 - 3	40	26
	King	2 - 3	40	7
Lake-View Premium Room with Hot-Spring Bath	Twin	2	40	4
	King	2	40	4
Junior Suite	-	2	58 - 60	2
Executive Suite	Twin	2	80	1
Dog-Friendly Room	Twin	2	30	6

*An extra bed (sofa bed) is available in the case of three occupants.
*All rooms are non-smoking.

Number of Guestrooms : 274 (596 guests)
Check-in 3:00 p.m. / **Check-out** 11:00 a.m.
Internet Environment : Wireless LAN connection (free of charge)
Facilities and Equipment
Air-conditioning, bathroom, toilet with bidet/washlet, TV, refrigerator, bath towels, hand towels, hand soap, shampoo, conditioner, body soap, toothbrushes, yukata, hair dryer, shaver, etc.
Rental Equipment
Thermometer, water pillows, nail clippers, hypoallergenic pillows, Blu-ray/DVD player, air purifier, humidifier, trouser press, baby cot, bath chair, wheelchair, etc.

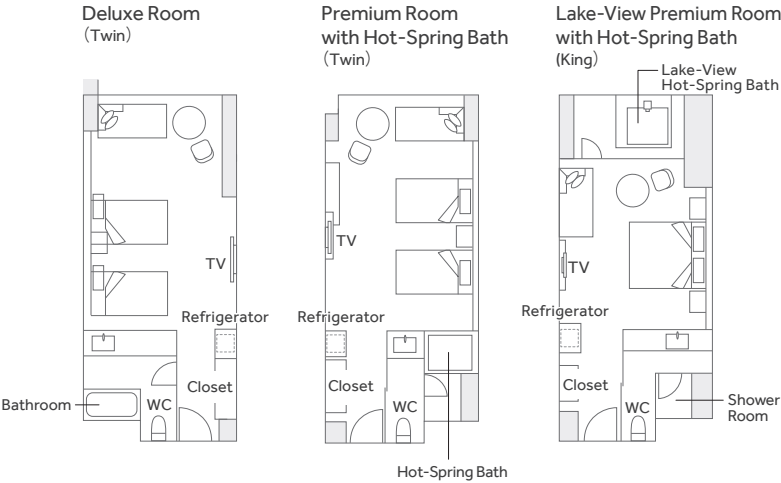
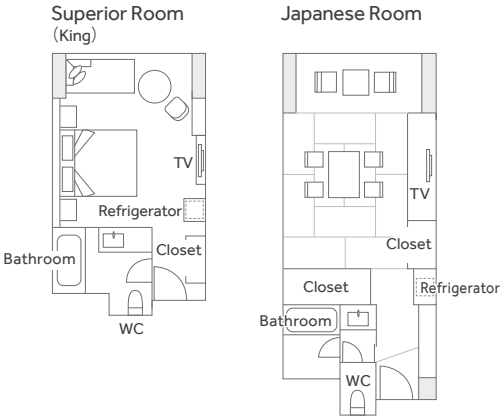

Japanese Room

FACILITIES

The hotel offers a restaurant where you can enjoy a unique resort dining experience with a spectacular view of Lake Biwa, as well as a full range of sports and wedding facilities. We are equipped to provide you with a comfortable hotel lifestyle.



Restaurant "Grill & Dining G"

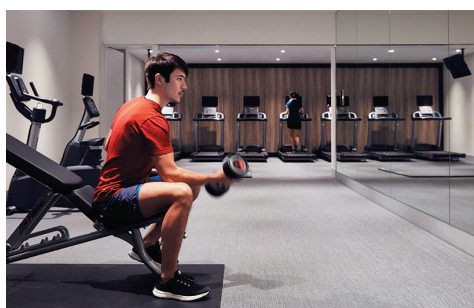

Fitness Center



Pool



Planetarium "Digital Star Dome HOTARU"

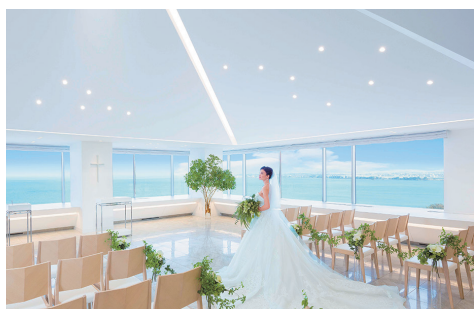

Chapel "The Sky"

RESTAURANT

Grill & Dining G / 12th Floor

We invite you to savor the bounty of the local Omi region while enjoying a panoramic view of Lake Biwa from the top floor.

[Opening Hours] Breakfast: 7 a.m.-11 a.m.(Breakfast Buffet: 7 a.m.-10 a.m.)

Lunch: 11:30 a.m.-2:30 p.m.(L.O.)

Dinner: 5:30 p.m.-10 p.m.(L.O. 9 p.m.)

[Number of Seats] 190 (Dining : 182, 1Private Room : 8)

LOUNGE

Lounge / 1st Floor

[Opening Hours] 3 p.m.-11 p.m.(L.O. 10 p.m.)

[Number of Seats] 57

HOT-SPRING BATH

Hot-Spring Bath / Sports Center 1st Basement Floor

[Opening Hours] Guests 6 a.m.-1:30 p.m./ 3 p.m.-12 a.m.

6 a.m.-0:30 p.m./ 3 p.m.-12 a.m.(Tuesday)

[Hot Spring Type] Sodium hydrogen carbonate and chloride spring

[Efficacy] Relieves fatigue, wounds, neuralgia, etc.

FACILITIES

Fitness Center / 1st Floor

[Opening Hours] Daily, 24 Hours [Fees] Free of charge for hotel guests

[Major Equipment] Treadmill, Elliptical Machine, Upright Bike, etc.

Pool (Indoor) / Sports Center 1st Basement Floor

[Opening Hours] 9 a.m.-9 p.m. [Fees] ¥830 per person for hotel guests

Tennis Courts(Outdoor) / Sports Center 1st Floor

[Opening Hours] Guests 7 a.m. to 11 p.m.

[Fees(1 Court, an hour)] ¥1,050 for hotel guests

[Facilities] 7 omni courts equipped with lighting for night games

Gymnasium / Sports Center 1st Floor

[Opening Hours] 9 a.m.-9 p.m. [Fees] Free of charge for hotel guests

Futsal Court(Outdoor) / Sports Center 1st Floor

[Opening Hours] 7 a.m.-11 p.m. [Fees(1 Court, an hour)] ¥4,400- for hotel guests

[Facilities] Two artificial turf courts [Rental] Shoes: ¥330, Ball: ¥770

Driving Range

[Opening Hours] 9 a.m.-9 p.m. [Fees(1 Court, an hour)] ¥550 for hotel guests

Bike Rental "GIANT STORE BIWAKOMORIYAMA" / Sports Center 1st Floor

[Opening Hours] 9 a.m.-7 p.m. *Closed on Tuesday

[Rental Fees(5 hours)] ¥3,900 for one Crossbike

Planetarium "Digital Star Dome HOTARU" / Sports Center 1st Floor

*Please see the website for the screening schedule, admission fees, and other details.

Lounge(Cozy Works LAKE BIWA) / 1st Floor

A working lounge for the exclusive use of hotel guests.

[Opening Hours] 7 a.m.-11 p.m. [Fees] Free of charge for hotel guests

*Use of the lounge requires ordering a food or beverage item between 11 a.m. and 10 p.m.

Chapel "The Sky" / 12th Floor

"Inner Ocean Grand Cross" / Water Forest 1st Floor

Shop / 1st Floor [Opening Hours] 9 a.m.-9 p.m.

Kids' Room / 1st Floor [Opening Hours] 10 a.m.-8 p.m.

Laundry Room / Sports Center 1st Floor [Opening Hours] 6 a.m.-12 a.m.

*All listed prices include the applicable consumption tax and service charge.

*Opening hours vary depending on the season and day of the week.



Sagawa Art Museum

This scenic museum overlooking Lake Biwa offers permanent displays of works by Japanese painter Hirayama Ikuo, sculptor Sato Churyo, and many other artists. The teahouse, which appears to float within a water garden, is also a popular spot for visitors. (About a 5-minute drive from the hotel)

SIGHTSEEING

Enjoy the diverse charms of Lake Biwa to the fullest

Lake Biwa, the largest lake in Japan. Come see the beautiful scenery of Lake Biwa, enjoy the natural environment that changes from season to season, and experience the history and culture of the Omi region.



Omihachiman Boat Tour

Omihachiman has prospered as a merchant town since ancient times. The town's canal district is considered one of the classic 'Eight Views of Lake Biwa,' and you can enjoy a relaxing tour by rowboat.

(About a 30-minute drive from the hotel)



Ukimido

The famous Ukimido (floating temple) is known as the site of wild geese returning home at Katata, one of the classic 'Eight Views of Omi.' The temple, which appears to float on the lake, and the ever-changing sky reflected upon the waters of Lake Biwa are must-sees.

(About a 15-minute drive from the hotel)

SEASONAL HIGHLIGHT

Gorgeous scenery along the shore that changes with the seasons

Flowers that beautify the seasons, spectacular autumn foliage, and more... Anywhere you go, you will be able to enjoy the vivid and ever-changing scenery surrounding Lake Biwa.



Autumn foliage at Ishiyamadera Temple

The temple is known for its association with Murasaki Shikibu, author of *The Tale of Genji*. In autumn, the temple grounds dyed crimson as the leaves change colors.

(Best time to see: Mid- to late November)



Omihachiman in spring

The tranquil and extensive canal district is decorated with cherry blossoms, rapeseed blossoms, and other seasonal flowers.

(Best time to see: Early to mid-April)

Fireflies in Moriyama

Fireflies are one of the special charms of early summer. They are fantastic to behold.

(Best time to see: Late May to Mid-June)



Car



Train

Tokyo	About 140 minutes	Kyoto	About 25 minutes	Katata	About 15 minutes by shuttle bus or taxi	Hotel
Nagoya	About 40 minutes	Kyoto	About 25 minutes	Moriyama	About 40 minutes by local bus	
Osaka	About 25 minutes	Kyoto	About 25 minutes	Moriyama	About 40 minutes by local bus	

*Free shuttle bus service is available from Katata Station. Please visit the website or contact us directly for details on the service schedule or other information.

LOCATION & ACCESS

Lake Biwa Marriott Hotel

2876 Imahama-cho, Moriyama Shiga 524-0101 Japan
T: +81 77-585-6100 F: +81 77-584-2100
www.marriott.com/osalb



*The information herein is current as of June 2024.