



NANKI-SHIRAHAMA MARRIOTT HOTEL



MARRIOTT
NANKI-SHIRAHAMA

RESORT MAP

About 75 minutes from Tokyo by plane, the Nanki-Shirahama Marriott Hotel is located at one of the Kansai region's finest resorts. The hotel has a pool and chapel on its grounds, and offers guests the kind of comfortable stay unique to a resort hotel.

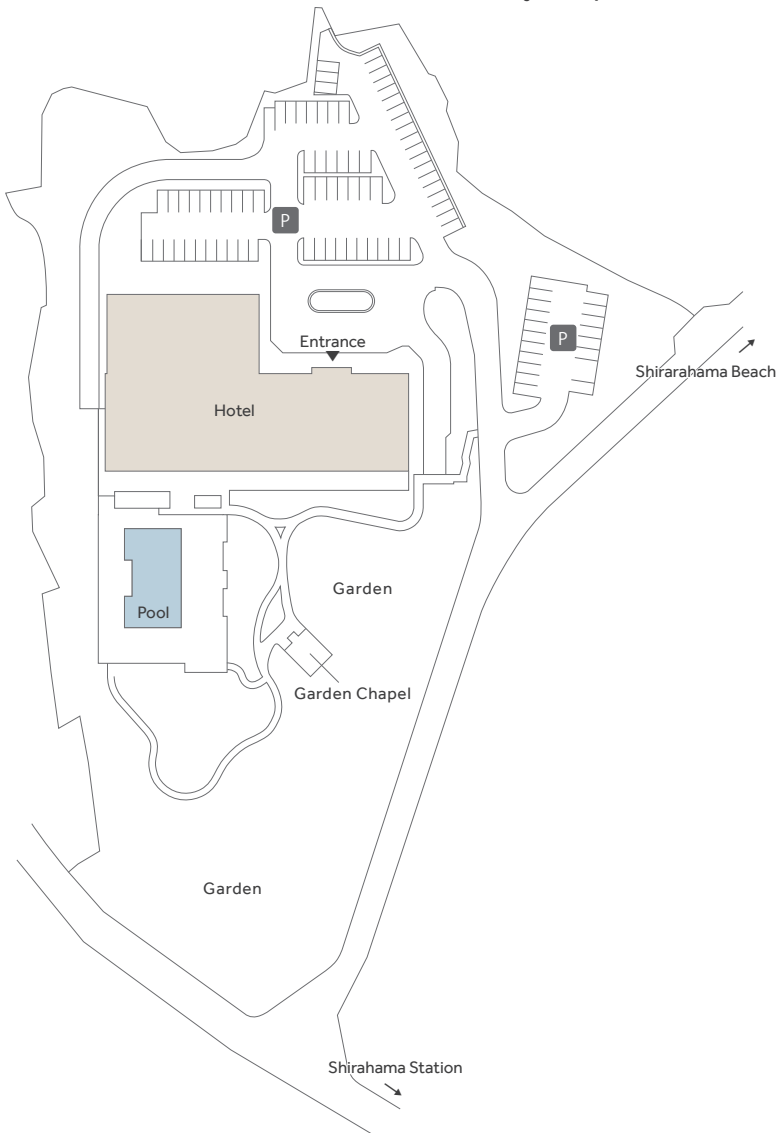

FLOOR PLANS

Enjoy a sparkling time at this seaside resort, where you can gaze at the ocean from every corner of the hotel. With a variety of colorful guest rooms, restaurants, and a panoramic hot spring on the top floor, the beauty of the sea is always within view.

1F

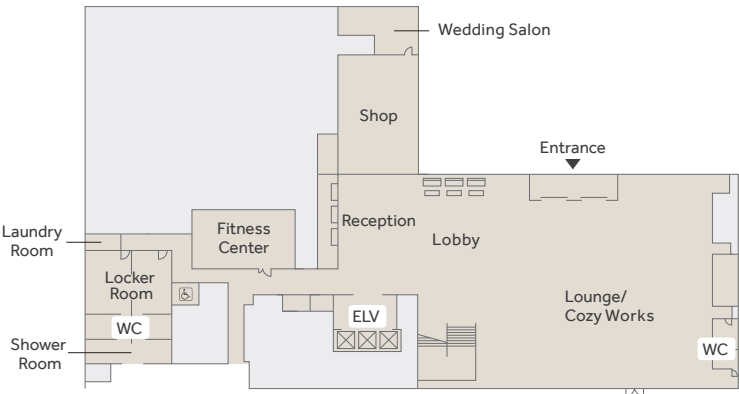

2F

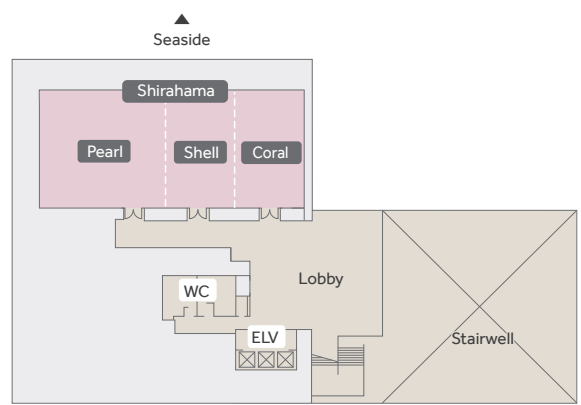

3F

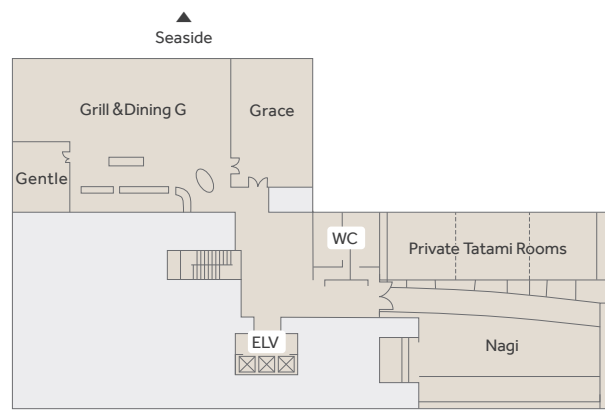

4F

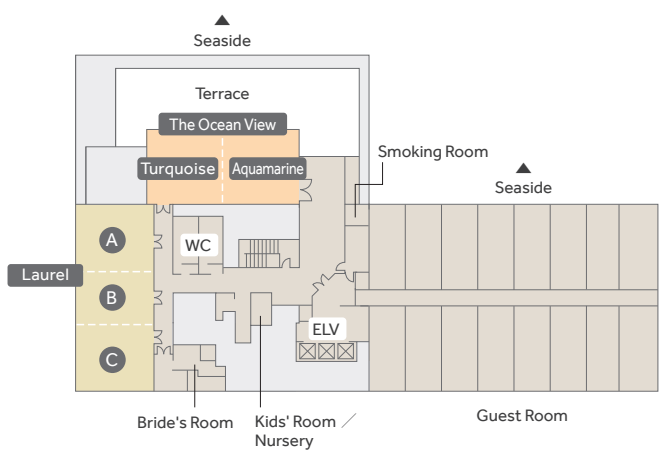

5-10F

Example: 5 to 9F

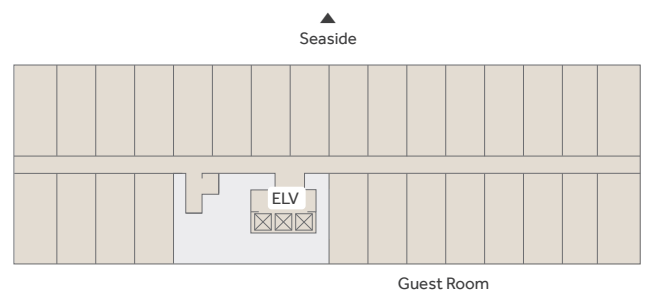

11F

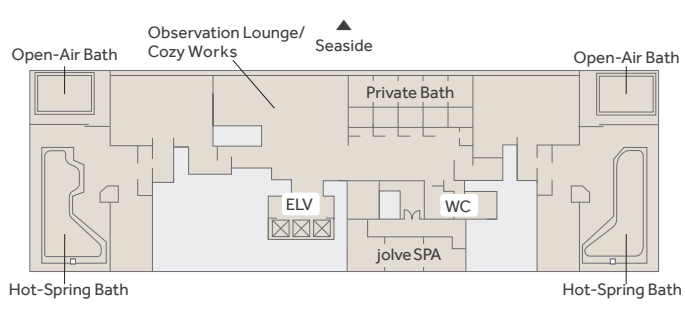

CONFERENCE & BANQUET ROOMS

Banquet rooms offer a spacious dedicated lobby, with, among other features, conference rooms overlooking the cobalt blue sea. These comfortable, functional spaces ensure that every MICE event is productive and meaningful.



The Ocean View



Laurel



Shirahama

The Ocean View 4F

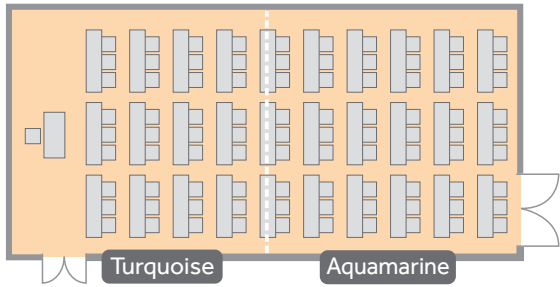

Laurel 4F

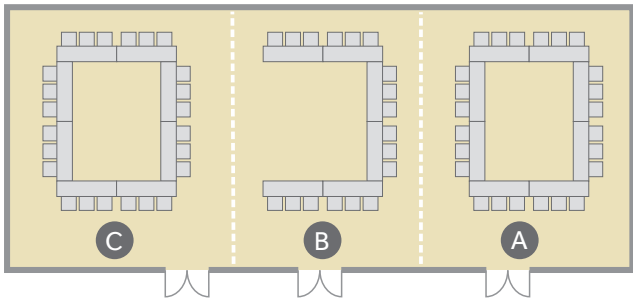

Name	Specification	Room Size (m²)	Ceiling Height (m)	Capacity			
				Theatre	Classroom	Hallow-Square	U-Shape
The Ocean View	All	144	2.7	135	90	54	48
	Aquamarine	72	2.7	49	36	30	24
	Turquoise	72	2.7	49	36	30	24
Laurel	All	150	2.5	130	99	—	—
	A	49	2.5	40	27	24	18
	B	45	2.5	40	18	24	18
	C	56	2.5	45	27	24	18

*Table size: 1,800 × 600 mm; The listed seating capacity assumes 3 guests per table

Internet Environment
Wireless LAN connection, wired Internet (free of charge)
Rental Equipment
Wireless microphones, whiteboards, screens, projectors, laser pointers, etc. (for a charge)

Shirahama 2F

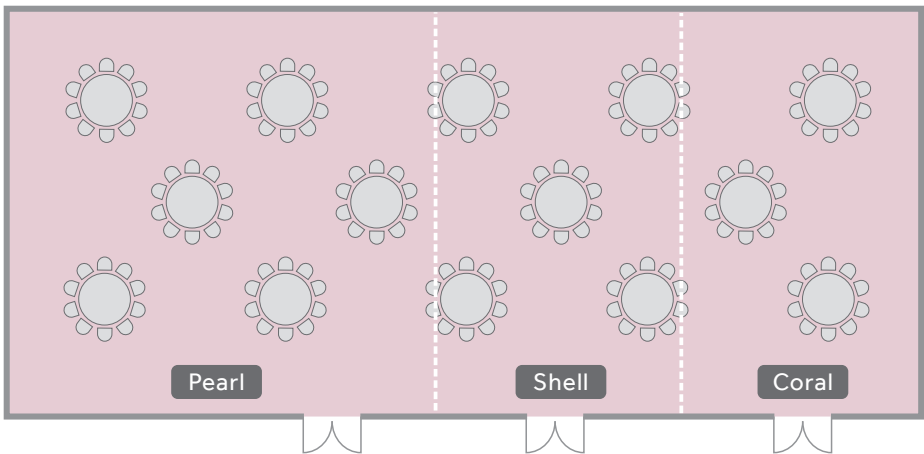

Name	Specification	Room Size (m²)	Ceiling Height (m)	Capacity	
				Standing Buffet	Banquet
Shirahama	ALL	338	3.8	200	140
	Pearl	130	3.8	80	50
	Shell	104	3.8	50	40
	Coral	104	3.8	50	40

Internet Environment
Wireless LAN connection, wired Internet (free of charge)
Rental Equipment
Wireless microphones, screens, projectors, etc. (for a charge)

GUEST ROOMS

At least 40m², the 182 guest rooms are spacious and graciously proportioned. Guests can choose their favorite from among eight unique room types, from ocean view rooms to rooms featuring a private hot spring bath.



Ocean-View Premium Room with Hot-Spring Bath (Twin)



Ocean-View Japanese-Western Room (Twin)

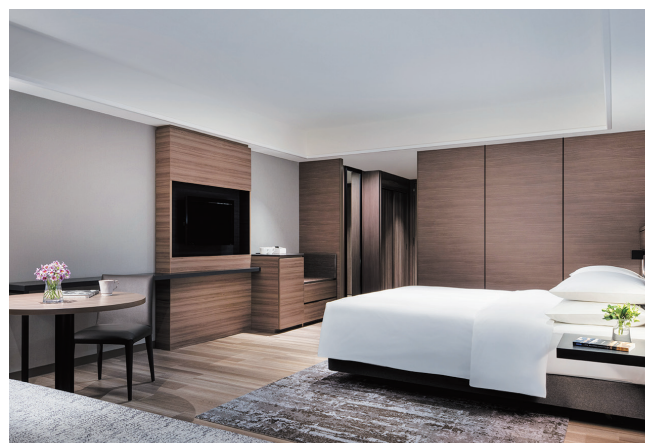

Superior Room (King)

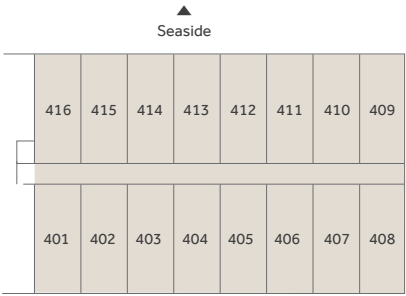

Guest Room		Occupancy	Room Size (m ²)	Number of Rooms
Superior Room*	Twin	2 - 3	4.2	16
	King	2 - 3	4.2	8
Japanese Room	-	2 - 4	4.2	16
Garden-View Japanese-Western Room*	Twin	2 - 5	4.2	24
	King	2 - 5	4.2	12
Ocean-View Japanese-Western Room*	Twin	2 - 5	4.2	36
	King	2 - 5	4.2	12
Deluxe Room	Twin	2	4.2	7
	King	2	4.2	3
Ocean-View Premium Room with Hot-Spring Bath	Twin	2 - 3	4.2	35
	King	2 - 3	4.2	11
Junior Suite	Twin	2	8.4	1
Executive Suite	King	2	8.4	1

*An extra bed (Futon for Japanese-Western Room) is available in the case of three or more occupants.
*All rooms are non-smoking.

Number of Guestrooms : 182 (380 guests)
Check-in 3:00 p.m. / Check-out 11:00 a.m.
Internet Environment : Wireless LAN connection (free of charge)
Facilities and Equipment
Air-conditioning, bathroom, toilet with bidet/washlet, TV, refrigerator, bath towels, face towels, hand towels, hand soap, shampoo, conditioner, body soap, toothbrushes, yukata, hair dryer, shaver, etc.
Rental Equipment
Thermometer, water pillows, nail clippers, hypoallergenic pillows, Blu-ray/DVD player, air purifier, humidifier, trouser press, baby cot, bath chair, wheelchair, etc.



Executive Suite

Example: 5F

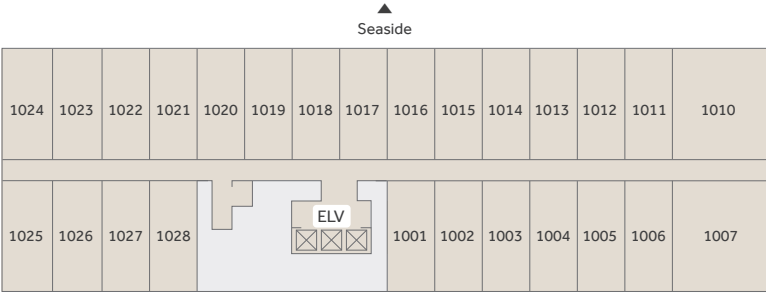
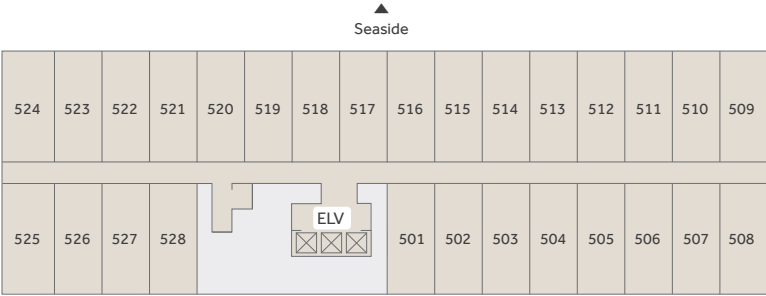

Superior Room (King)

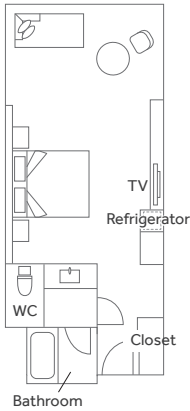

Japanese Room

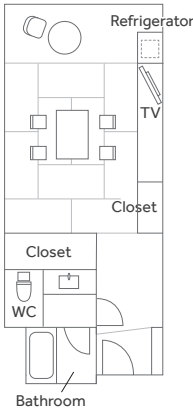

Japanese-Western Room (Twin)

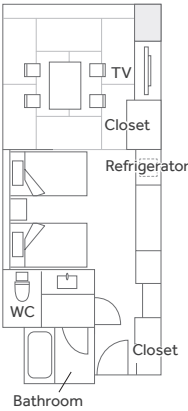

Deluxe Room (King)

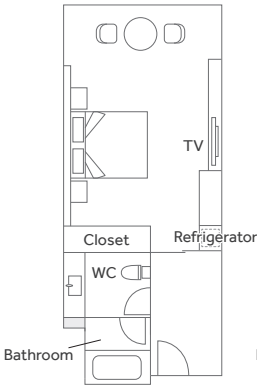

Ocean-View Premium Room with Hot-Spring Bath (Twin)

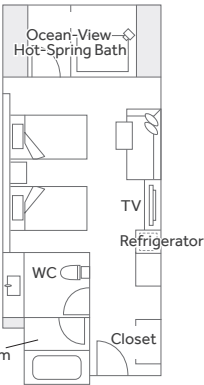

FACILITIES

A wide variety of services are available to ensure guests enjoy a comfortable stay. Guests will find themselves refreshed in body and mind, whether taking in the stunning views from the hot spring bath or enjoying a meal at our restaurant.



Restaurant "Grill & Dining G"



Lounge



Hot-Spring Bath

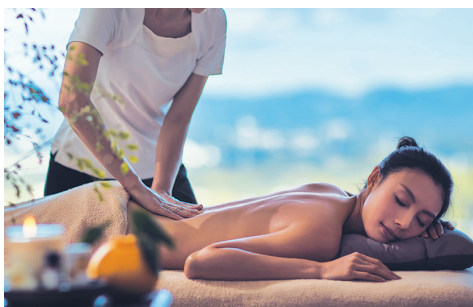

Spa "jolve SPA"



Pool



Garden Chapel

RESTAURANT

Grill & Dining G / 3rd Floor

In a spacious setting with panoramic views of the Pacific Ocean, Grill & Dining G offers a menu incorporating a variety of fresh seafood along with bountiful ingredients from the Nanki region.

[Opening Hours] Breakfast: 7 a.m.-11 a.m.

Dinner: 5:30 p.m.-10 p.m.(L.O. 9 p.m.)

[Number of Seats] 180 (Dining : 120, Private Room "Grace": 48, Private Room "Gentle":12)

LOUNGE

Lounge / 1st Floor

[Opening Hours] 11 a.m.-11 p.m.(L.O. 10 p.m.)

[Number of Seats] 50

HOT-SPRING BATH

Shirahama Onsen, one of Japan's three most historic hot springs. Guests can luxuriate in a hot spring bath with expansive views of the ocean from the top floor of the hotel.

Indoor Bath, Open-Air Bath / 11th Floor

[Opening Hours] 5 a.m.-10 a.m., 12 p.m.- 0 a.m.

[Hot Spring Type] Sulfur with sodium and chloride, hydrogen carbonate spring

[Efficacy] Burn,Wound, Dermatitis, Neuralgia, etc.

Private Bath(5 Rooms) / 11th Floor

[Opening Hours] 5 a.m.-10 a.m., 2 p.m.- 0 a.m.

[Fees(1 Room, 50 minutes)] ¥1,650 -

[Hot Spring Type] Sulfur with sodium and chloride, hydrogen carbonate spring

[Efficacy] Burn,Wound, Dermatitis, Neuralgia, etc.

SPA

jolve SPA / 11th Floor

Relax and heal in our spa, which offers an exclusive menu of services that take advantage of ingredients unique to Shirahama, or enjoy our other exquisite treatments.

[Opening Hours] 3 p.m.-10 p.m.

FACILITIES

Fitness Center / 1st Floor

[Opening Hours] Daily, 24 Hours [Fees] Free of charge for hotel guests

[Major Equipment] Treadmill, Elliptical Machine, Upright Bike, etc.

Pool(Outdoor)

[Opening Hours] 9 a.m.-5 p.m. [Fees] Free of charge for hotel guests

*Open only during the summer season

Cozy Works NANKI-SHIRAHAMA / 1st Floor, 11th Floor

This generously proportioned working lounge is uniquely designed for resort users, offering a bright, sunlit space and seating with expansive views of the ocean.

[Opening Hours] 7 a.m.-10 p.m. [Fees] Free of charge for hotel guests

Garden Chapel (Outdoor)

Shop / 1st Floor [Opening Hours] 8 a.m.-9:30 p.m.

Kids' Room, Nursery / 4th Floor [Opening Hours] Daily, 24 Hours

Laundry Room / 1st Floor [Opening Hours] Daily, 24 Hours

*All listed prices include the applicable consumption tax and service charge.

*Opening hours vary depending on the season and day of the week.



Adventure World

At this popular theme park you can encounter an adorable family of pandas. The whole family can enjoy a day at this park, where you can see animals close up, and which also features amusement park rides and other attractions.
(About a 10-minute drive from the hotel)

SIGHTSEEING

A holiday in Nanki,
both active and relaxing

Guests can enjoy their time at the resort as they wish, whether taking in the incredible natural scenery, enjoying the historic hot springs and cobalt blue sea, or visiting a theme park where cute pandas make their home.



Engetsu Islet

Engetsuto (round-moon islet), a symbol of Shirahama, was named for the circular sea cave carved out of its center. The views in the evening are spectacular, and the site has been selected as one of the "100 Best Sunsets in Japan."
(About a 5-minute drive from the hotel)



Shirarahama Beach

One of the Kansai region's finest beaches, Shirarahama Beach extends its white sands for almost 620 meters, highlighting the contrast with the deep blue sea. A fireworks display is held in summer, attracting large crowds.
(About a 3-minute walk from the hotel)

ACTIVITY

Enjoying nature
and culture in Nanki

The beautiful ocean, and majestic Kumano. In Nanki, where nature and history remain unchanged since ancient times, visitors can touch eternity through experiences unique to the region.



Underwater Mailbox (Diving)

Drop a postcard in the world's deepest mailbox, located on the sea floor at about 10 meters. Mail can also be sent overseas.



Snorkeling

Recommended for those looking for an easy way to explore under the sea. This is something even children and beginners can try.

Kumano: Heian Period Costumes

Try on a Heian period kimono and veiled straw hat for a walk to the Kumano Hongu Taisha shrine and other highlights of the Kumano pilgrimage route.



*Some activities may not be available depending on the season. Please inquire for details of rates, operating days and other information.

Car



Train

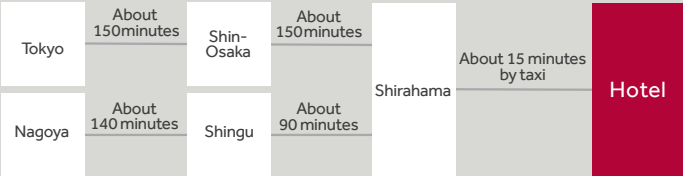

Plane

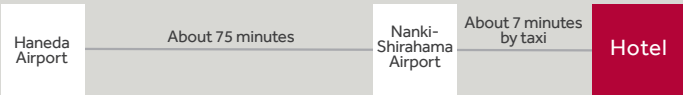

LOCATION & ACCESS

Nanki-Shirahama Marriott Hotel

2428 Shirahama-cho, Nishimuro-gun, Wakayama 649-2211 Japan
T: +81-739-43-2600 F: +81-739-43-8001
www.marriott.com/osana



*The information herein is current as of June 2024.